



12 28 Argyle Street , Liverpool, L1 5DL £1,200

We are delighted to offer for RENT this Penthouse 5th Floor apartment. Comprising spacious landing area, open plan living area with fitted kitchen, two double bedrooms, En-suite and bathroom. Located on Argyle Street, parallel to Duke Street and lies in the popular Ropewalks area of the city, which is characterised by 19th century warehouses and merchants houses.

The property benefits from double height sloped ceilings and balconies offering wonderful City views.

The apartment itself comprises the following:

Rent £1200 pcm excluding bills
EPC Rating D
Council Tax C
Minimum term 6 months
Available from 12th April

Viewings highly recommended to appreciate all that this apartment offers.

- Fifth Floor Apartment
- Allocated Unground Parking
- Two Bedrooms
- Bathroom & En-Suite
- Lovely City Views
- Balcony
- City Centre Location
- Council Tax Band C
- EPC Rating D
- Available early April

Viewing

Please contact our Michael Moon Office on 0151 924 1000 if you wish to arrange a viewing appointment for this property or require further information.



Floor Plan

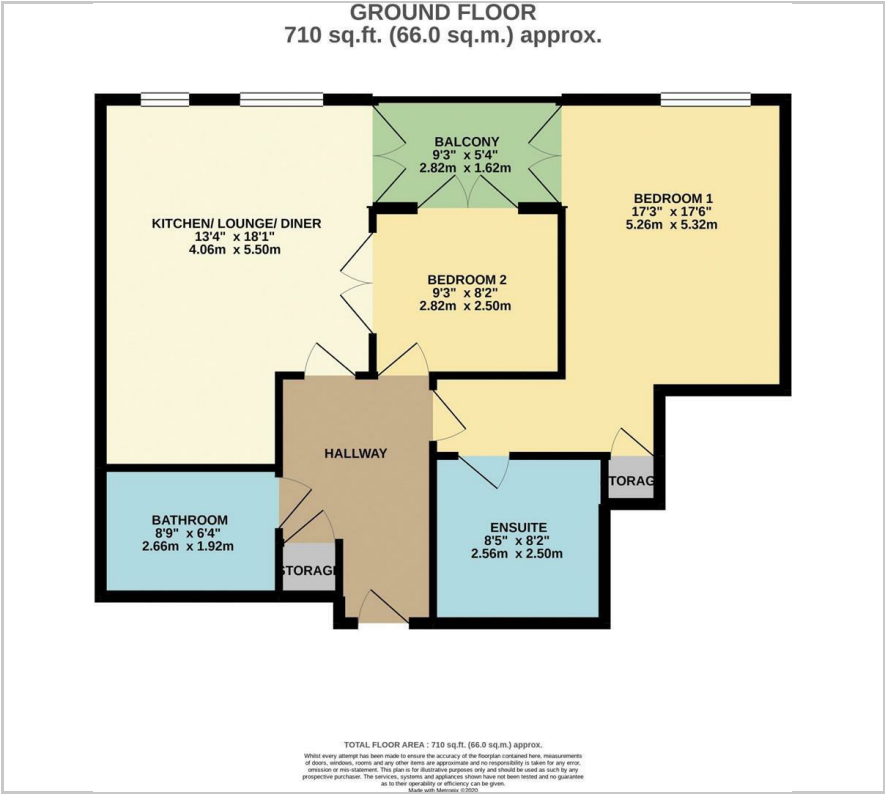

Area Map

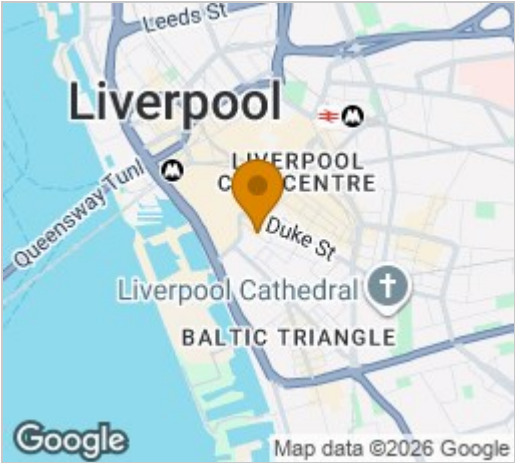

Energy Efficiency Graph

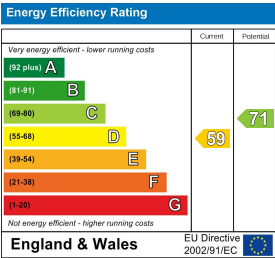

These particulars, whilst believed to be accurate are set out as a general outline only for guidance and do not constitute any part of an offer or contract. Intending purchasers should not rely on them as statements of representation of fact, but must satisfy themselves by inspection or otherwise as to their accuracy. No person in this firms employment has the authority to make or give any representation or warranty in respect of the property.